

Niesmann-Clou Modelländerung Clou L 600

1988

Datenblatt

Aufbau

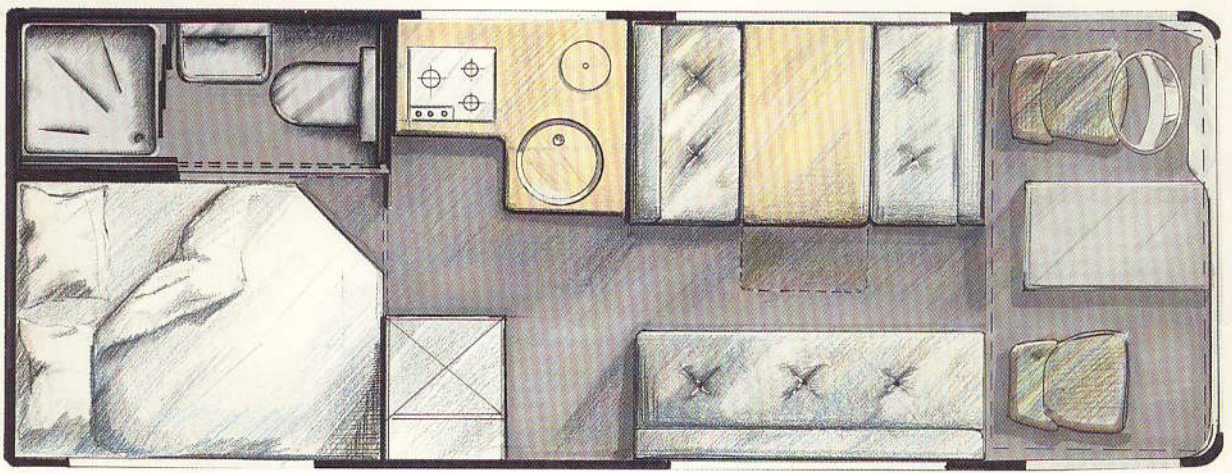
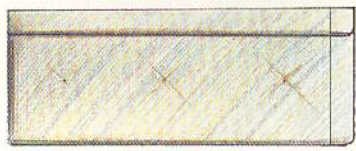

Clou L 600

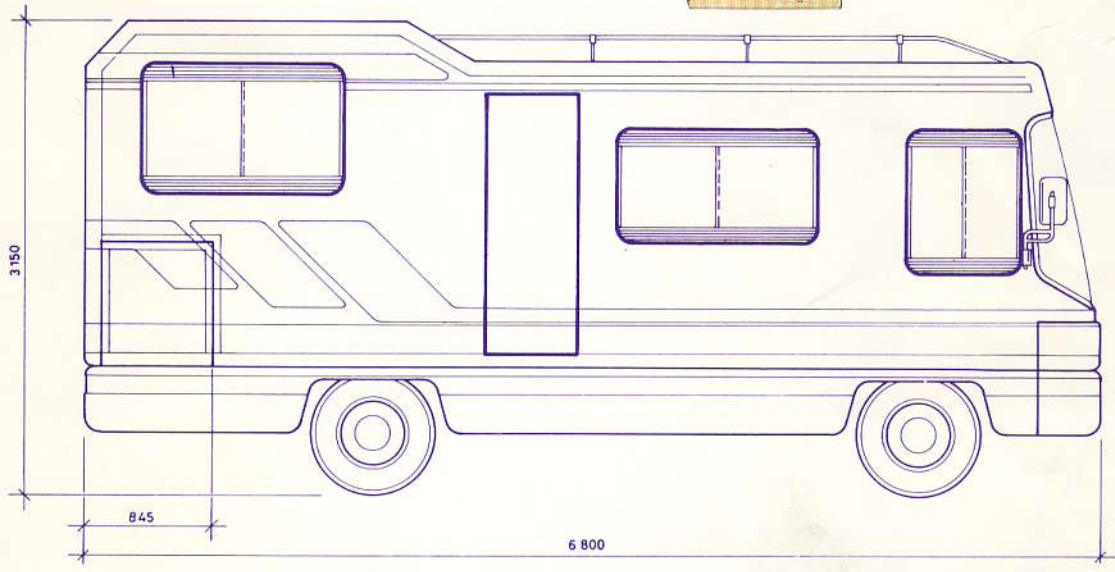
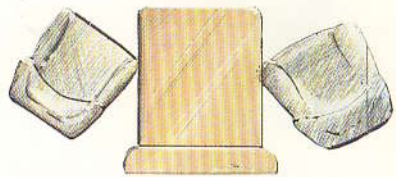

TYP Radstand (mm):	L 600 VW LT 55 Turbo Diesel 3650	L 600 IVECO 65-12 Turbo Diesel 3600	L 600 IVECO 79-14 3600
zul. Gesamtgewicht	5.600 kg	6.700 kg	7.490 kg
Eigengewicht	4.600 kg	5.200 kg	5.400 kg
Zuladung	1.000 kg	1.500 kg	2.090 kg